

# ROYSTON & LUND



## Hine Hall, Mapperley, Nottingham

£850 Per Month

- Two Bedroom Ground Floor Apartment
- Open Plan Kitchen Diner And Living Room
- Close By To Numerous Amenities
- Leasehold - Council Tax Band - A
- Gated Estate With Ample Off Street Parking
- Three Piece Suite Bathroom
- Excellent Transport Links
- Space For Summer Seating To The Front Overlooking Treeline
- Integrated Kitchen Appliances
- EPC Rating - D

1 Victoria Road, Tamworth, Staffordshire, B79 7HL  
01827 66686

tamworthenquiries@royston-lund.co.uk  
www.royston-lund.co.uk

### Ground Floor

Approx. 44.4 sq. metres (478.3 sq. feet)

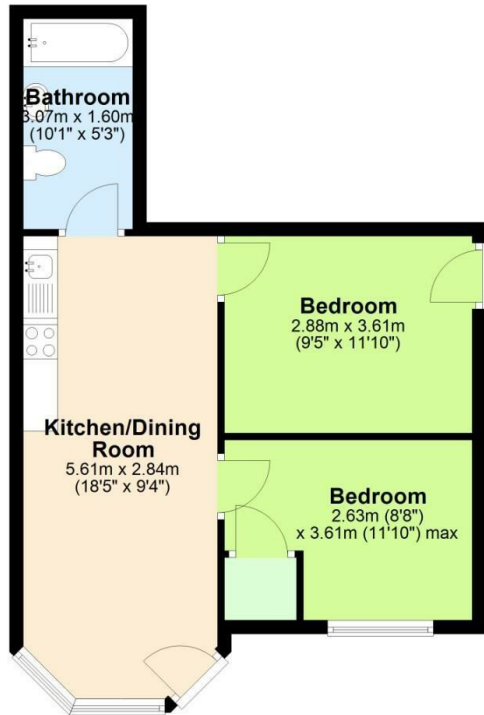

Total area: approx. 44.4 sq. metres (478.3 sq. feet)

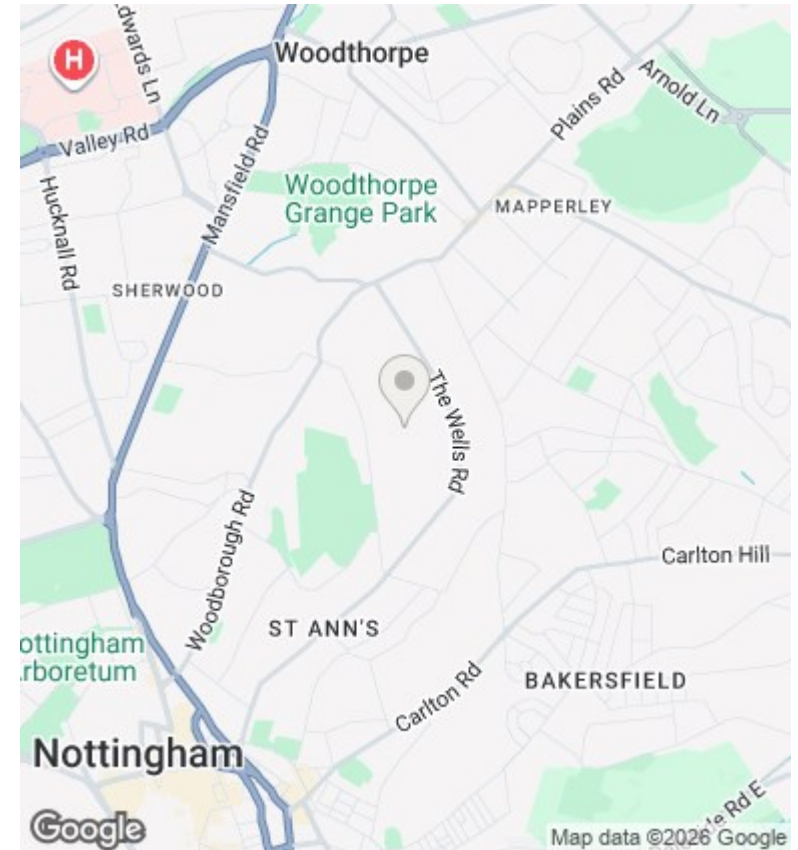

### Directions

### Viewings

Viewings by arrangement only. Call 01827 66686 to make an appointment.

### Council Tax Band

A

### EPC Rating:

D

Energy Efficiency Rating		
	Current	Potential
<i>Very energy efficient - lower running costs</i>		
(92 plus) <b>A</b>		
(81-91) <b>B</b>		
(69-80) <b>C</b>		<b>78</b>
(55-68) <b>D</b>	<b>62</b>	
(39-54) <b>E</b>		
(21-38) <b>F</b>		
(1-20) <b>G</b>		
<i>Not energy efficient - higher running costs</i>		
<b>England &amp; Wales</b>	EU Directive 2002/91/EC	